

# Geothermal Power Plant at Hellisheiði

Main supply pipelines for a geothermal plant.

**Key quantities:**

Earth work – from quarry	300.000 m <sup>3</sup>
Earth work – excavation	40.000 m <sup>3</sup>
Earth work – compacted fillings	42.000 m <sup>3</sup>
Concrete	1.030 m <sup>3</sup>
Reinforcing Steel	60 tons
Steel pipes ø700	3.050 m
Steel pipes ø1000	2.900 m
Pre-cast concrete supports, 5 types	1300 stk.
Steel supports and holders 900 pcs.	265 tonn

**Client:**  
Orkuveita Reykjavíkur

**Period:**  
Feb 2005 – Nov 2005

**Architects:**  
Landslag ehf.

**Engineers:**  
VGK Engineering

**ÍSTAK's services:**  
Main Contractor

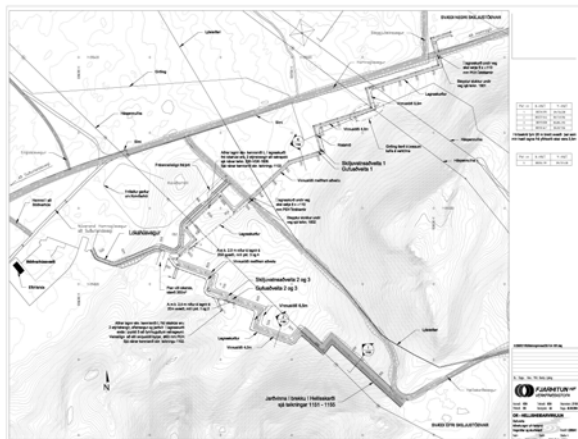
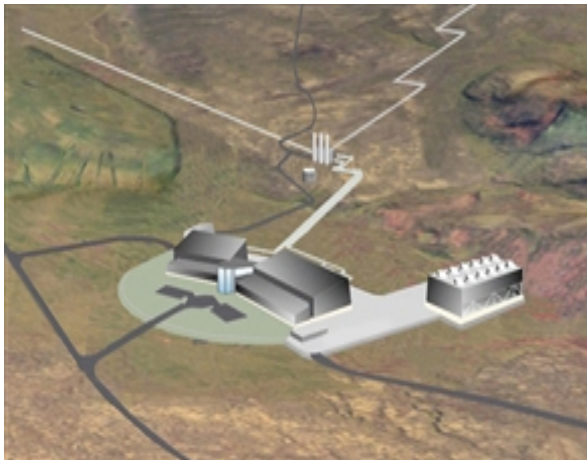

**Address:**  
ÍSTAK Ltd.  
Engjateigur 7  
105, Reykjavík, Iceland

**Phone:** +354 530 2700

**Fax:** +354 530 27 24

**E-mail:** [istak@istak.is](mailto:istak@istak.is)

**Web page:** [www.istak.is](http://www.istak.is)